



+ GPO - Installation Guide

1x Floorsight-GPO Lagoon Connector
8x 3*16mm wood screws

[illegible]

	
--	---

1



89mm

60mm

If the desk does not have a pre-drilled hole then you will need to do this with a 3.5 inch holesaw. Press the floorsight module firmly into the hole.

Diagram 2 shows the floorsight module being pressed into the 89mm hole. The module is a cylindrical unit with a mesh screen. The diagram shows the module being lowered into the hole, with the mesh screen visible inside. The hole is labeled '89mm'.

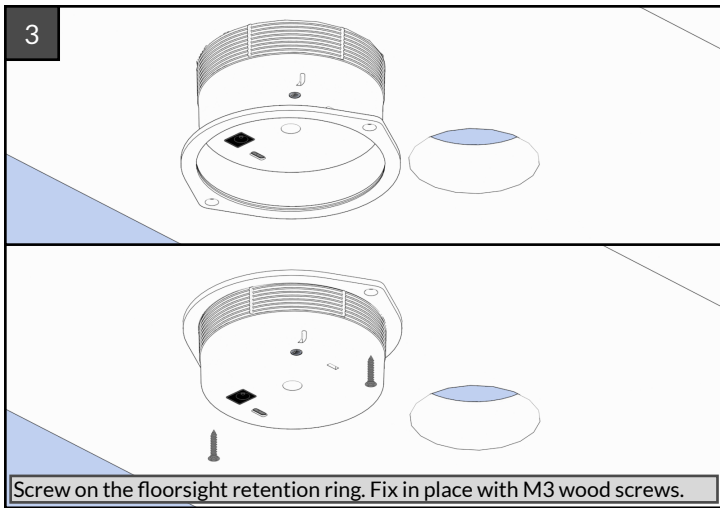

Screw on the floorsight retention ring. Fix in place with M3 wood screws.

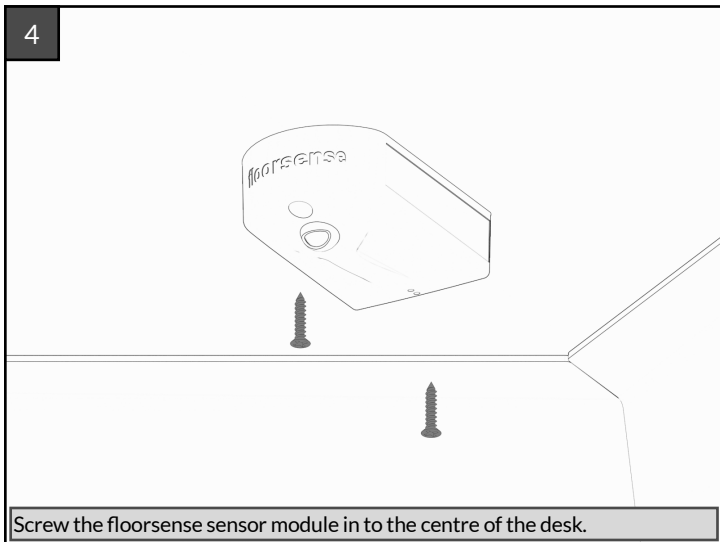

Screw the floorsense sensor module in to the centre of the desk.

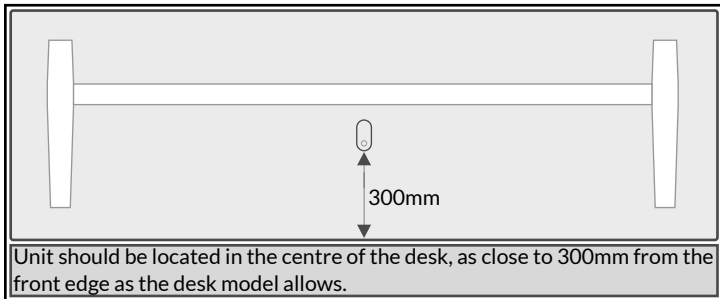

Unit should be located in the centre of the desk, as close to 300mm from the front edge as the desk model allows.

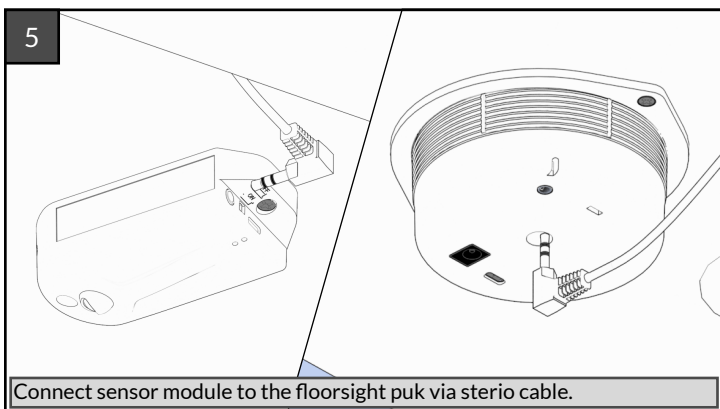
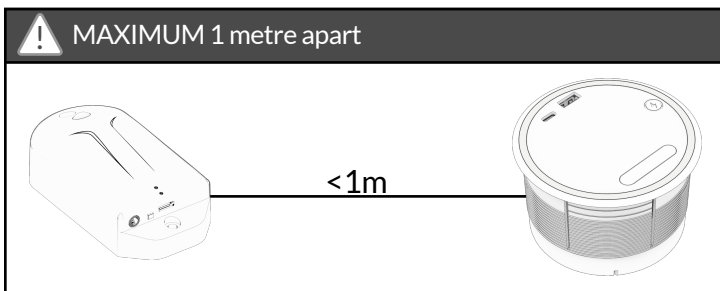

Connect sensor module to the floorsight puck via stereo cable.

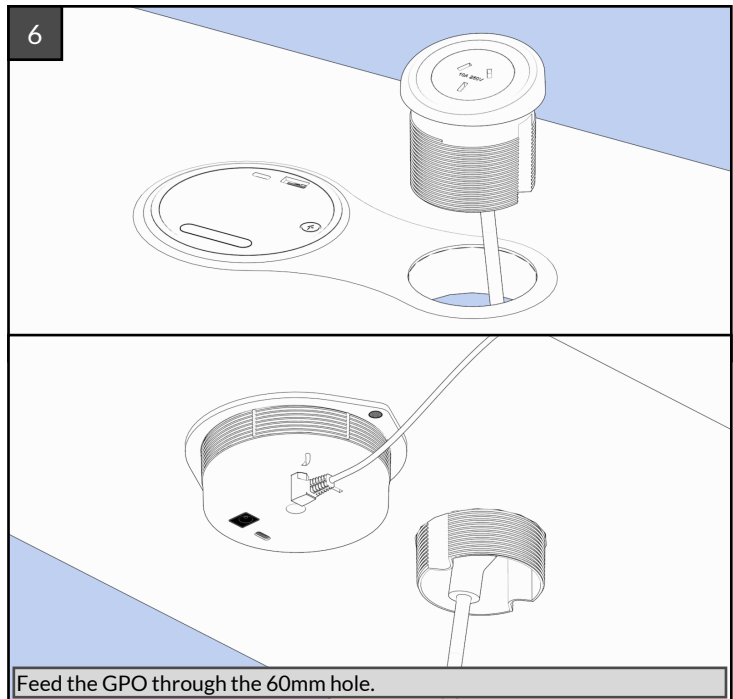

Feed the GPO through the 60mm hole.

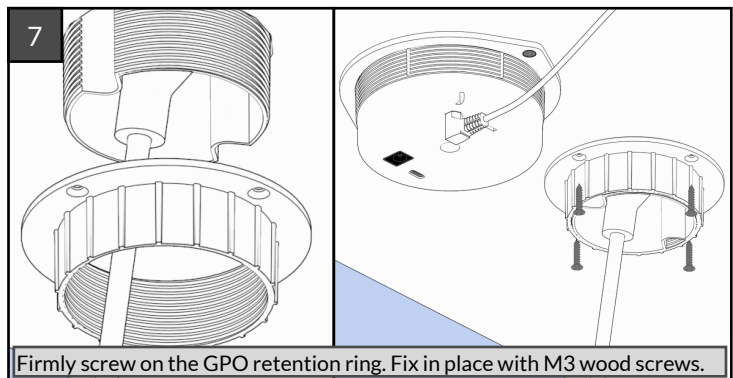

Firmly screw on the GPO retention ring. Fix in place with M3 wood screws.

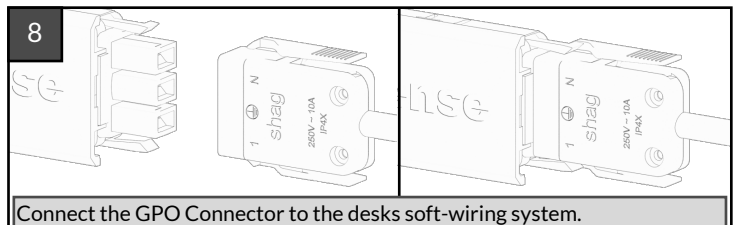

Connect the GPO Connector to the desks soft-wiring system.

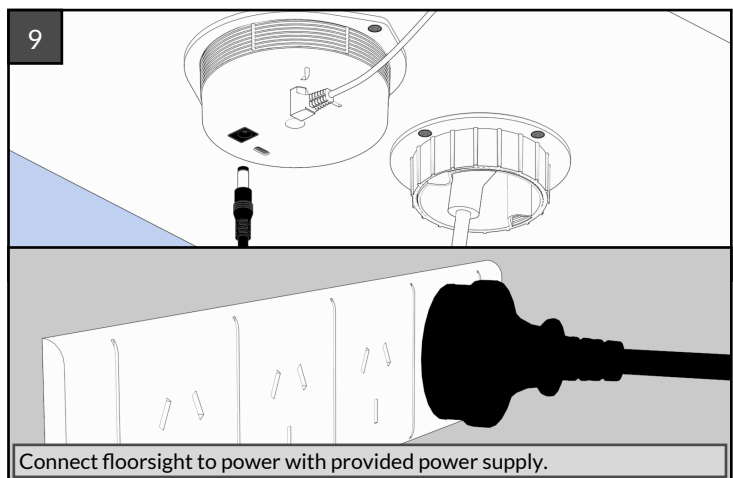

Connect floorsight to power with provided power supply.

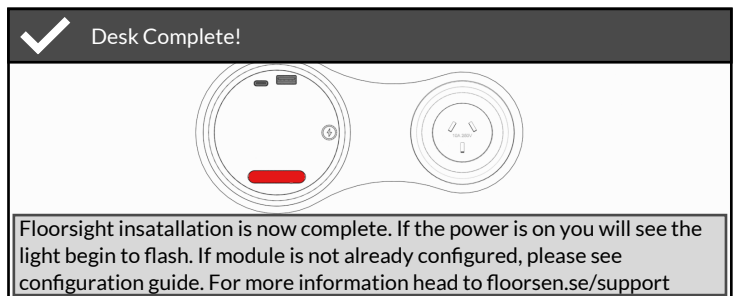

✓ Desk Complete!

Floorsight insatallation is now complete. If the power is on you will see the light begin to flash. If module is not already configured, please see configuration guide. For more information head to floorsen.se/support

