

floorsense

V2 Installation Guide

Parts included:

2x



1x Floorsense Sensor Unit
2x 3mm wood screws



B

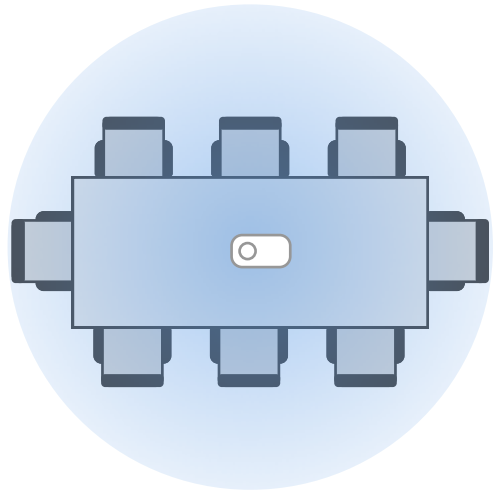

Sensor should be fixed to ceiling in the centre of the room

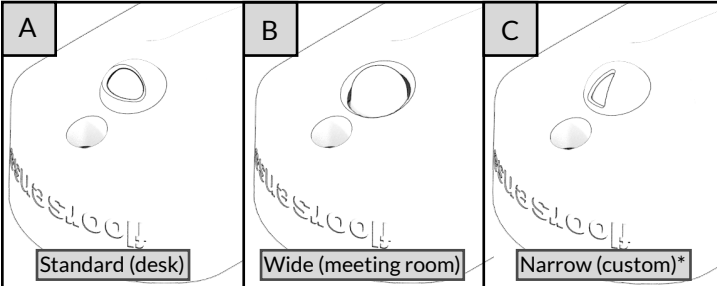

Avoid moving parts of adjustable height desks

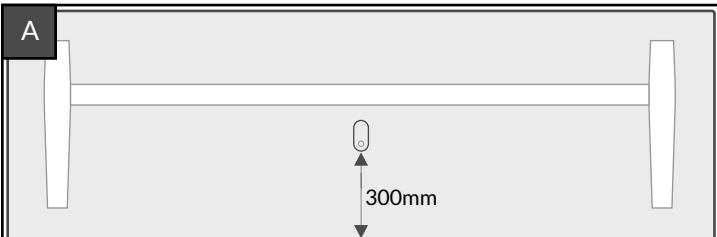
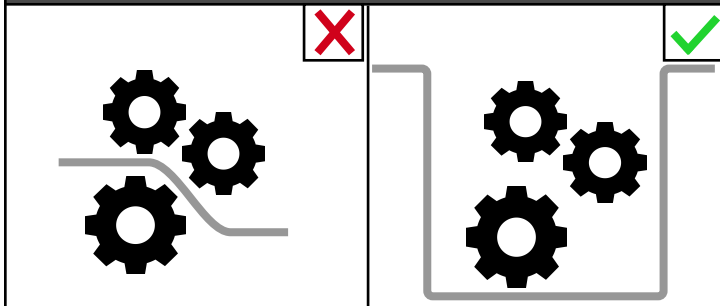

Unit should be located in the centre of the desk, as close to 300mm from the front edge as the desk model allows.

A1

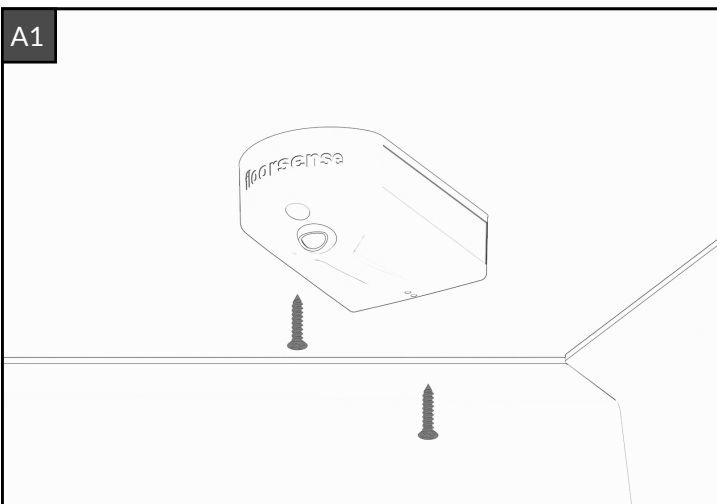

Screw the floorsense sensor module in to the centre of the desk.

B1

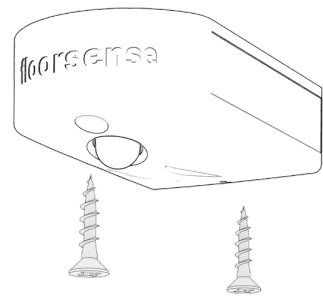

Fix sensor to ceiling. depending on the ceiling material, you may need to source specialty screws (plasterboard etc.) or use screw anchors

2

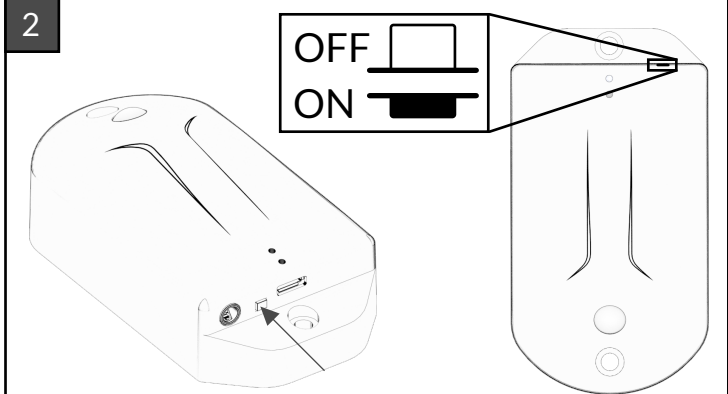

Press button in to turn module on. The LED should begin flashing.

Installation LED Progressions

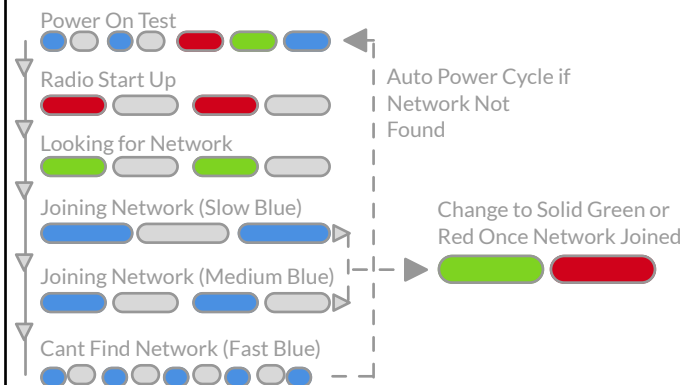

* For more information head to floorsen.se/contact