

Smartalock Locker Mapping Guide

Confirming Lockers are Connected

Once all lockers are connected and showing green lights, a prompt will ask to confirm the amount of lockers that are connected and if you have different type's of lockers (Big, Small, Top, Bottom, etc...)

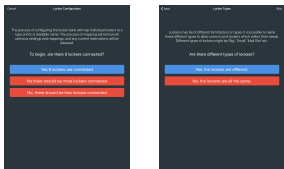

Locker Types

If you select Yes to locker types, input the the type of locker and then close the corresponding lockers. You may do this for as many locker types as you want until all lockers have been closed.

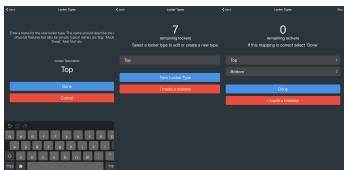

note: locker type's cannot be created after mapping locks so it is best to create type's even if they wont be used initially.

Locker Naming

Now you are able to give the lockers a naming scheme of your choice using either just number, a prefix or a suffix. commonly used is B1-01 (Bank 1-Locker 1) or L2-01 (Level 2-Locker 1).

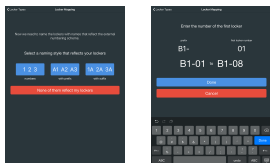

Locker Mapping

Once a naming sheme has been selected you will be asked to close the locker door's corresponding to their name starting with locker 01,02,03 and so on.

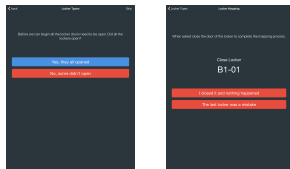

Bank Details

Once mapping is completed you will be able to enter the details of the locker bank including organisation and building names etc... Then you will be asked to add alternative information although you may skip this step by pressing next.

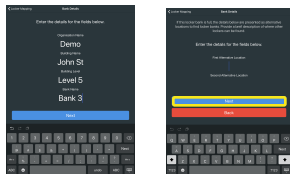

Overview

Now you will be sent to the Kiosk admin screen, Here you can change the previously entered details or change other Bank settings. Press exit to return to the home screen and complete mapping.

