

# floorsight

## Installation Guide

### Full Package:

Floorsight  
GPO  
Sensor  
NoSwipeNoPower  
Sit/Stand Motor Control

### Parts included:

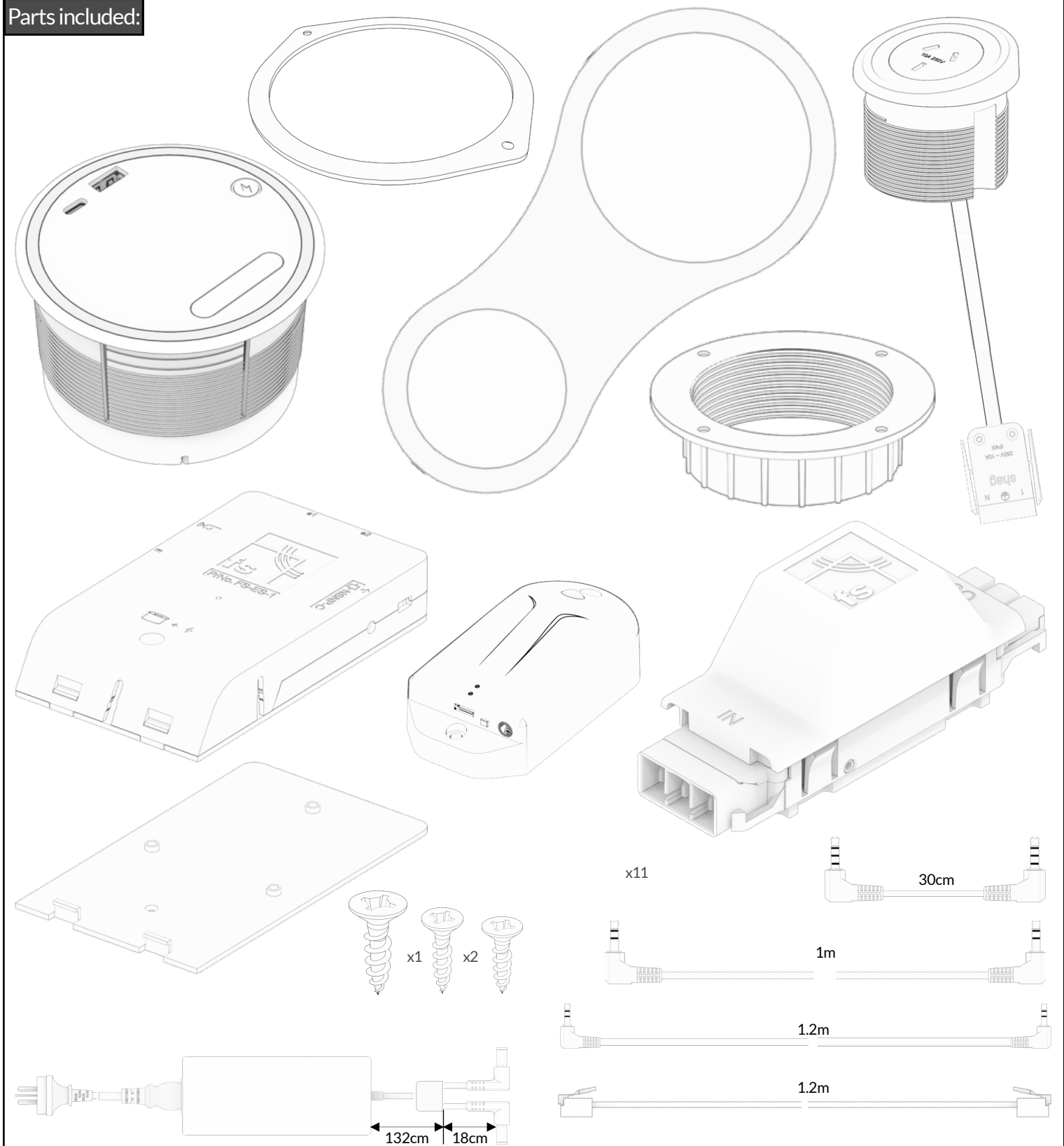

1x Floorsight Power Puck

1x 89mm Retention Ring

1x Floorsight sensor

1x Desk Mounted General Purpose Outlet

1x 60mm Retention Ring

1x Floorsight-GPO Lagoon Connector

1x Floorsight Splitter Module

1x Floorsight Splitter Mounting Plate

1x NoSwipeNoPower Module

1x 4\*25mm Wood Screw

11x 3\*16mm Wood Screw

2x 3\*20mm Wood screw

1x 30cm 3.5mm 4-pin Audio Cable

1x 1m 3.5mm 3-pin Audio Cable

1x 1.2m 2.5mm 3-pin Audio Cable

1x 1.3m RJ11 Cable

1x Y-split 24V DC Power Supply

⚠ Ensure underside of desk is clear before drilling through.

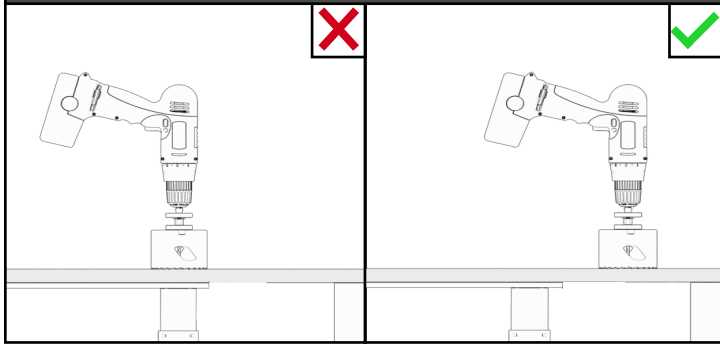

1

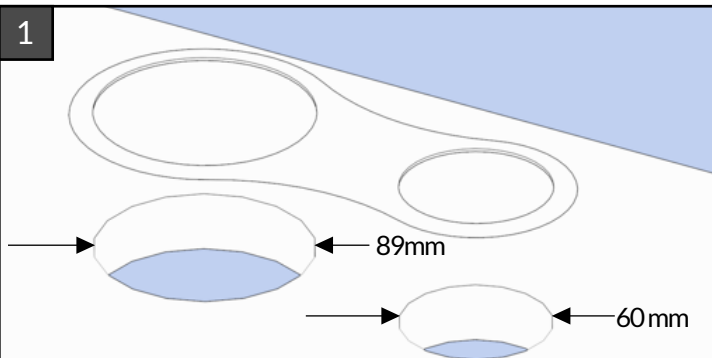

If the desk does not have a pre-drilled hole then you will need to do this with both a 3.5 (89mm) inch and 60mm holesaw. See accompanying drawing for detail.

2

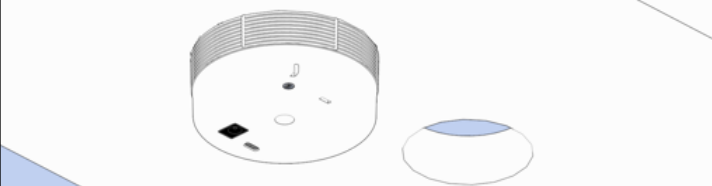
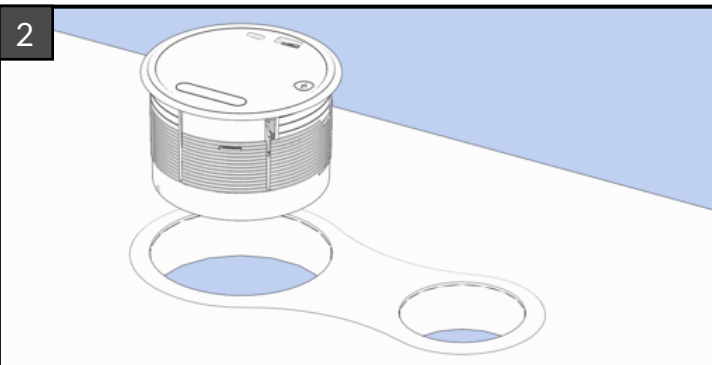

Place the lagoon over holes. Press the floorsight module into the 89mm hole.

3

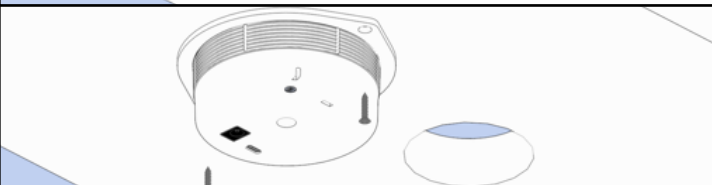
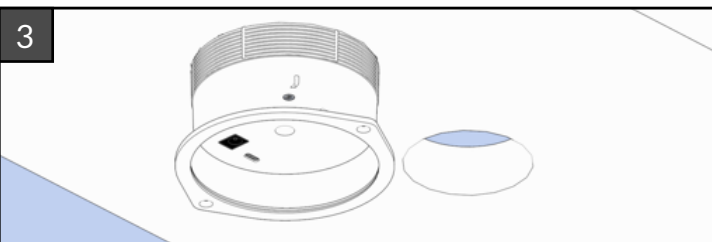

Screw on the floorsight retention ring. Fix in place with 3x16mm wood screws.

4

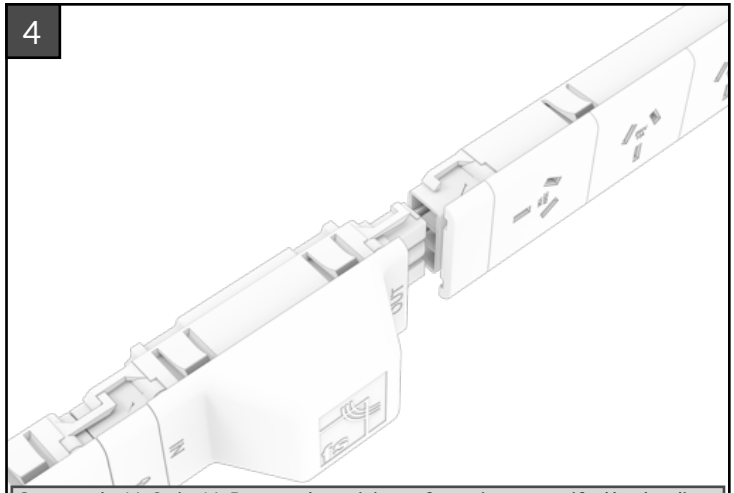

Connect the NoSwipeNoPower relay unit in configuration as specified by the client. There needs to be at least 2 AC power outlets BEFORE the relay.

5

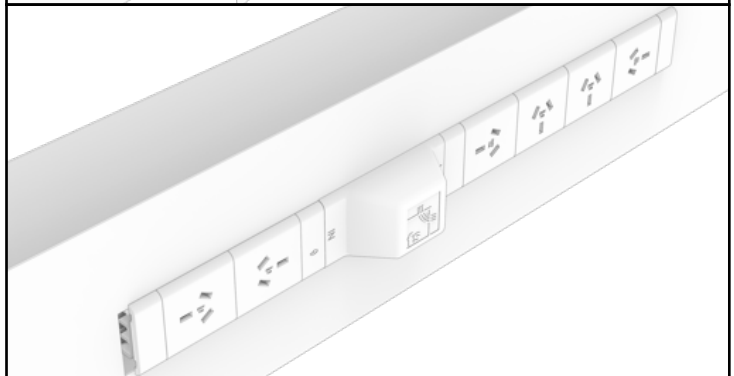
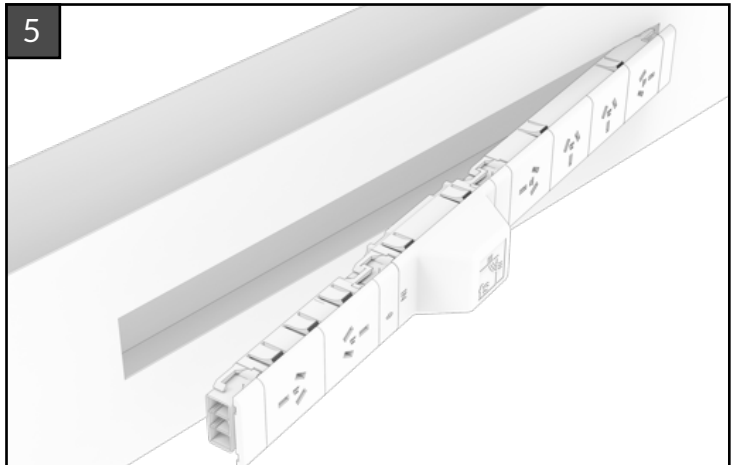

Install NoSwipeNoPower unit as specified by client.



MAXIMUM 0.2 metres apart

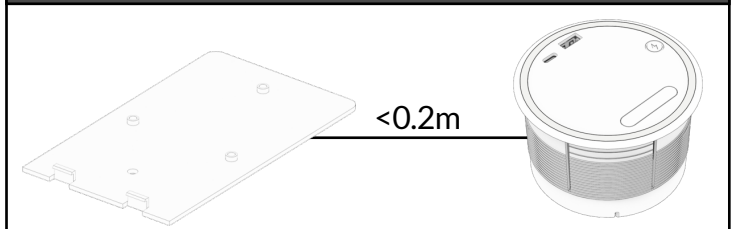

6

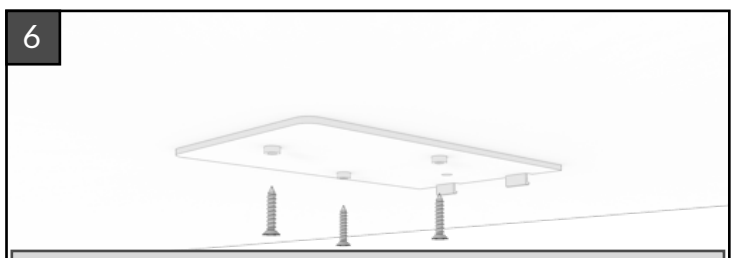

Screw mounting plate to underside of desk with 3x16mm wood screws, no further than 0.2m from the floorsight puck. DO NOT OVERTIGHTEN SCREWS

7

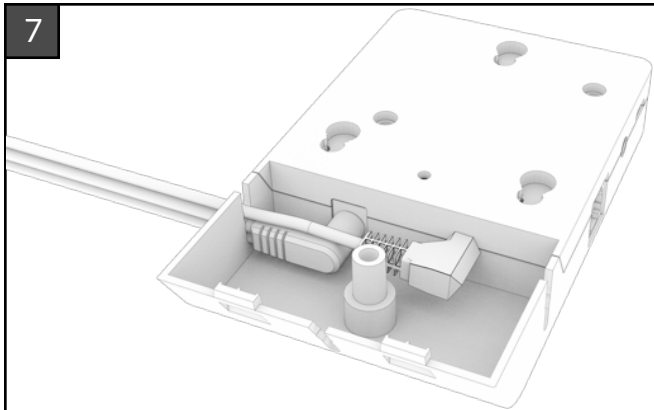

Plug 24V DC power connector and short (30cm) 3.5mm audio cable. Press into slots on side of enclosure.



**ENSURE AUDIO CABLE IS INSERTED ENTIRELY**



8



Press the splitter onto the mounting plate, aligning the screws with mounting holes. Slide the unit until it clips firmly into position. (Optional: Lock in place with 4x25mm wood screw).

9

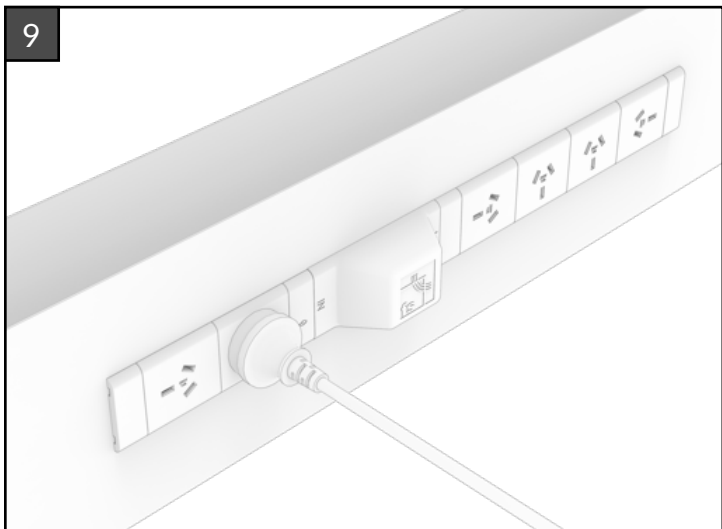

Insert the power cable into an AC outlet upstream of the relay unit.



**Avoid moving parts of adjustable height desks**

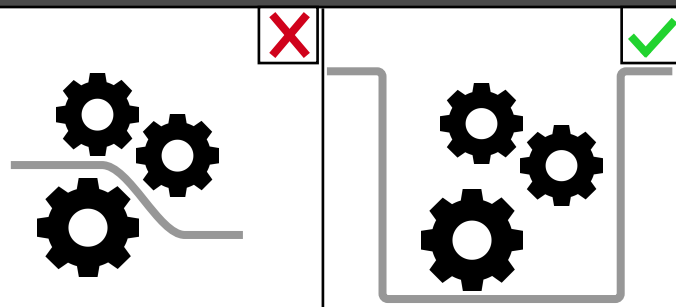

10

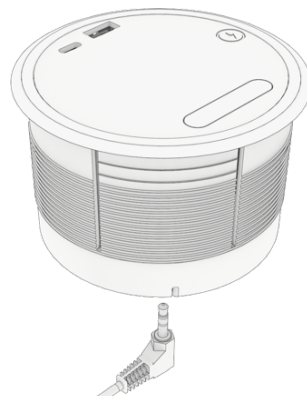

Insert the loose end of the short (30cm) 3.5mm audio cable into the floorsight puck.

11

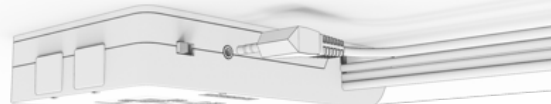

Insert 2.5mm (1.2m) audio cable into the splitter. Insert the other end into the NoSwipeNoPower relay unit.

12



Screw the floorsense sensor module in to the centre of the desk.



**MAXIMUM 1 metre apart**

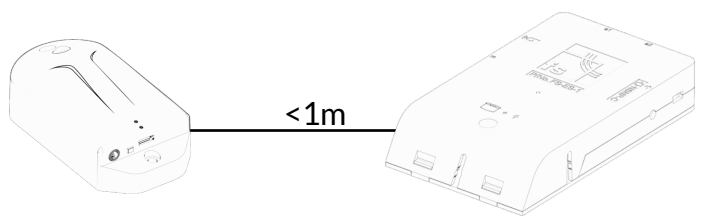

13

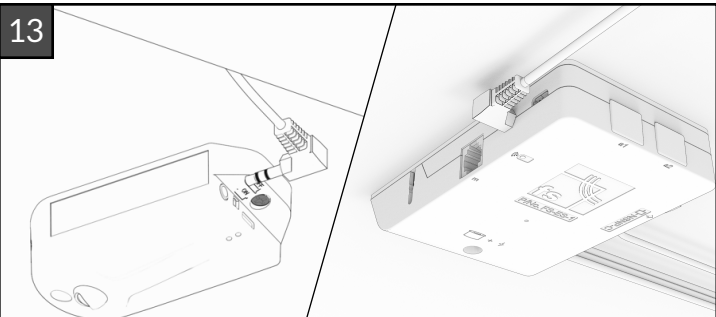

Connect sensor module to the floorsight splitter via 1m stereo cable. Connect the splitter to the floorsight module. See splitter installation instructions for more detail.

14

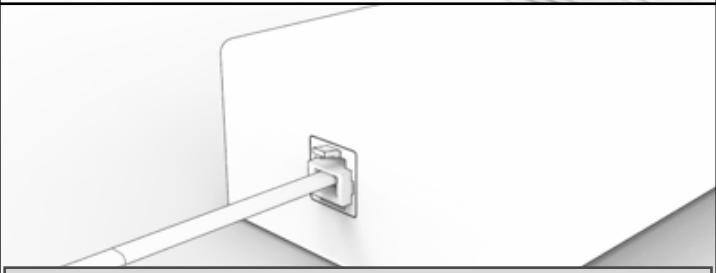
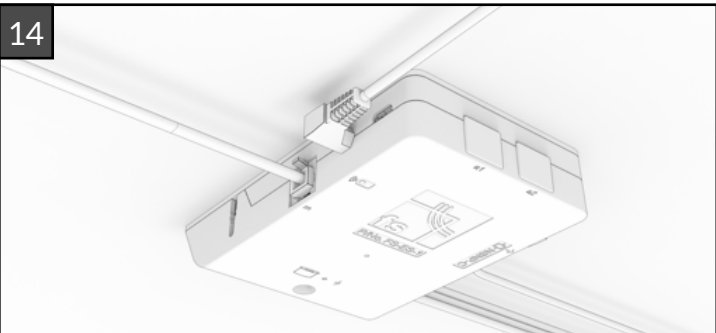

Insert the RJ11 cable to the floorsight. Insert the other end into the sit-stand motor controller. Motor controller installation instructions should be provided by the desk manufacturer.

15

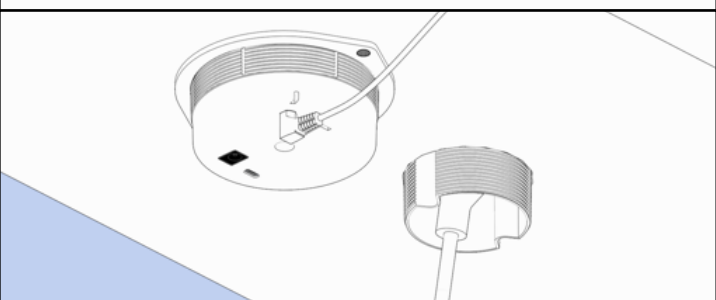
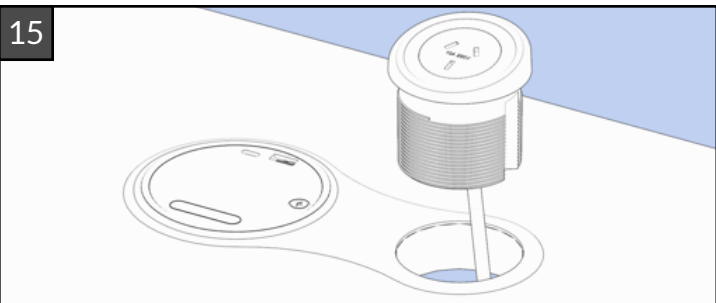

Feed the GPO cable through the 60mm hole and press into place firmly.

16

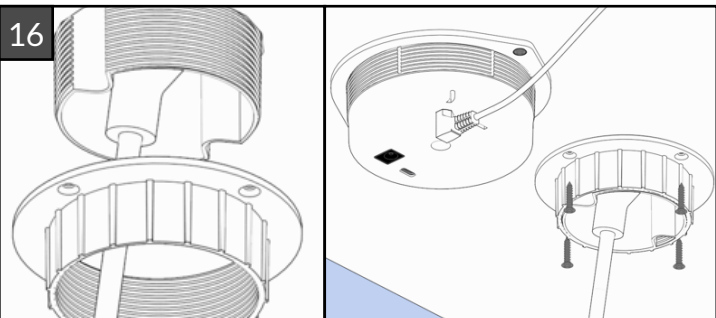

Firmly screw on the GPO retention ring. Fix in place with 3x16mm wood screws.

17

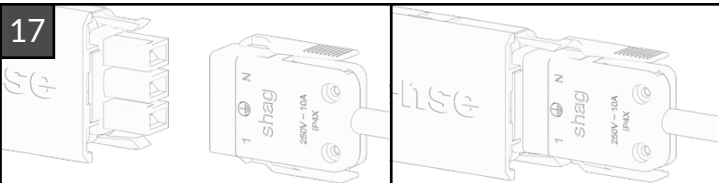

Connect the GPO Connector to the desks soft-wiring system.

18

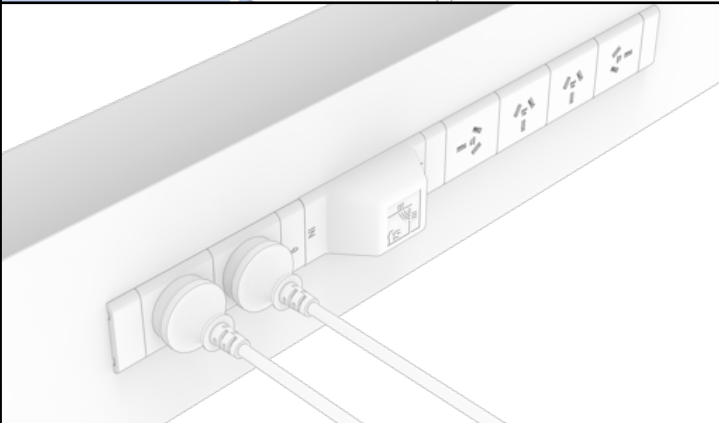
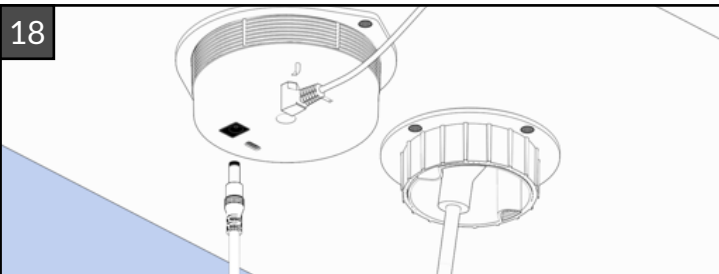

Insert free 24V DC connector into floorsight puk. Insert the power cable into an AC outlet upstream of the relay unit.

19

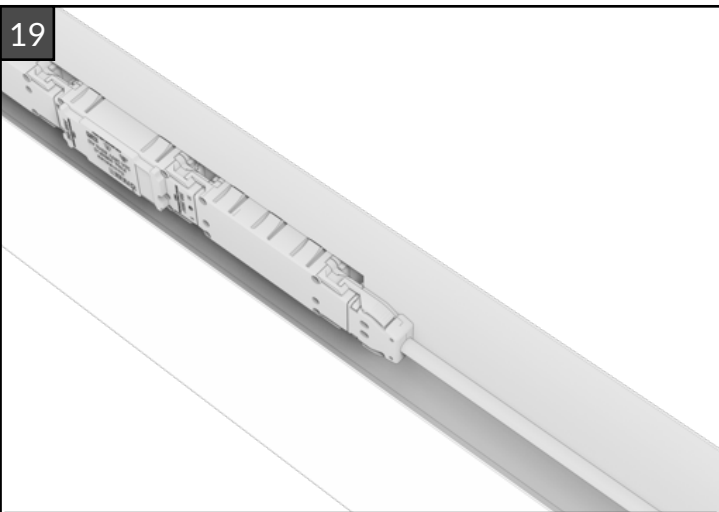

Connect desk power chain to upstream power.



Installation Complete!

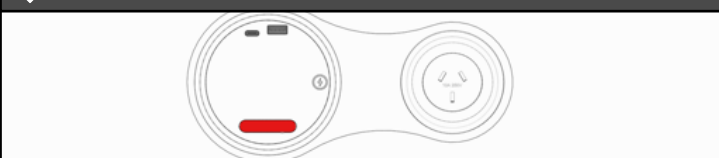

Floorsight insatallation is now complete. If the power is on you will see the light begin to flash. If module is not already configured, please see configuration guide. For more information head to [floorsen.se/support](https://floorsen.se/support)

# Floorsight Relay Configuration

